



MasterTap™

Keg Capacity Guide

For Direct Draw Coolers

Models DB36, DB52, DB60, DB72, DB84, DB108



Intertek

Conforms TO UL Std 471
Certified to CSA Std C22.2 #120



Keg Capacity Guide

For Direct Draw Coolers

MasterTap™



Typical
Half Barrel

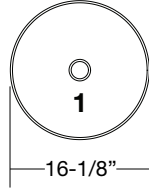

Typical
Quarter Barrel

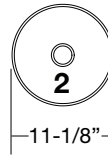

Typical
Sixth Barrel

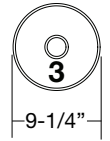

Single Door Units

Models beginning with DB36

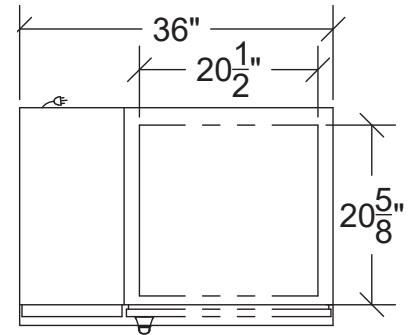

20" x 20-5/8" Inside Cabinet

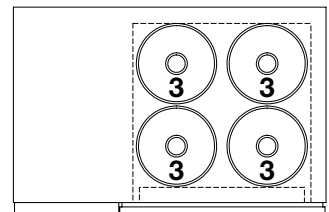
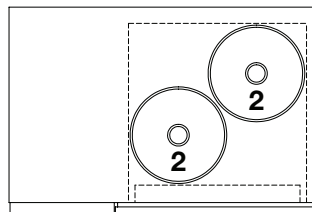
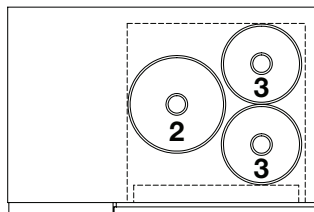
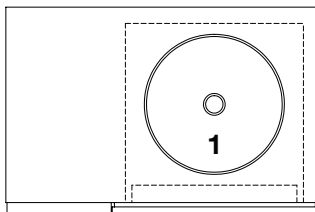



Keg Capacity Guide

For Direct Draw Coolers

MasterTap™



Typical
Half Barrel

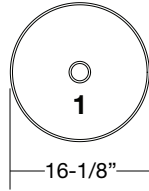

Typical
Quarter Barrel

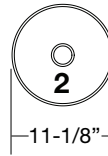

Typical
Sixth Barrel

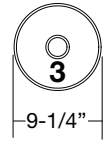

Two Door Units

Models beginning with DB52

NOTE: DB52 models have narrow doors and cannot fit Half Barrels

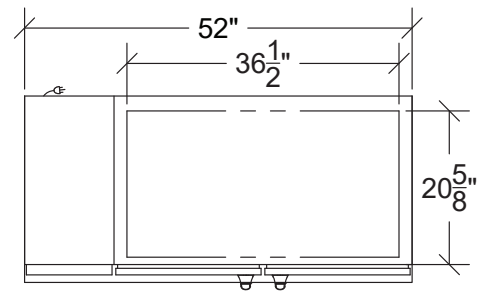

36-1/2" x 20-5/8" Inside Cabinet

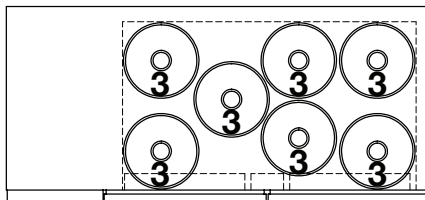
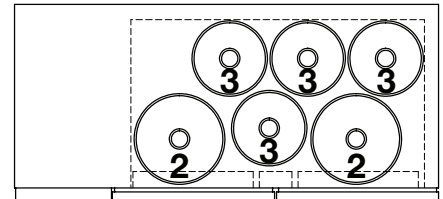
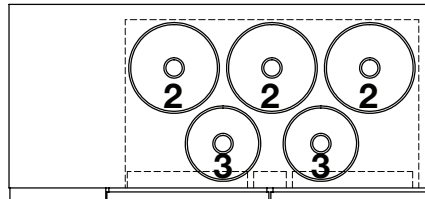
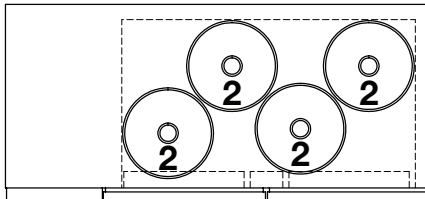



Keg Capacity Guide

For Direct Draw Coolers

MasterTap™



Typical
Half Barrel

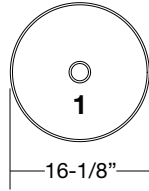

Typical
Quarter Barrel

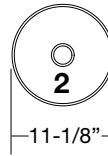

Typical
Sixth Barrel



Two Door Units

Models beginning with DB60

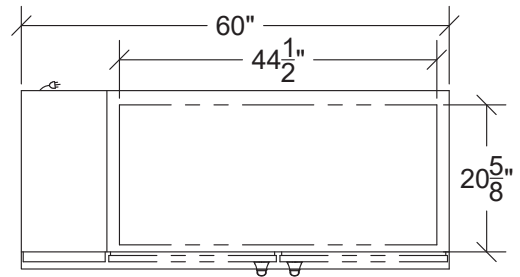

44-1/2" x 20-5/8" Inside Cabinet

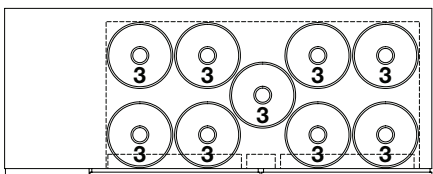
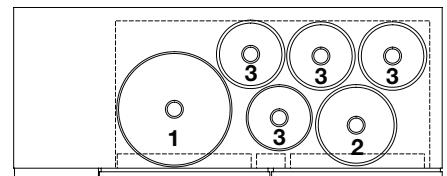
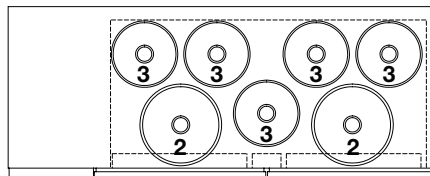
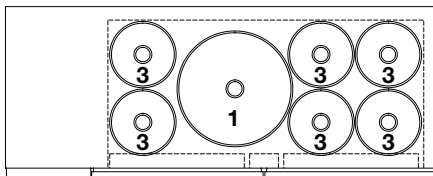
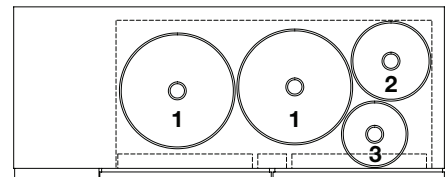
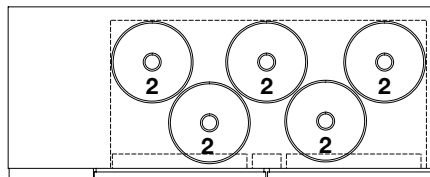
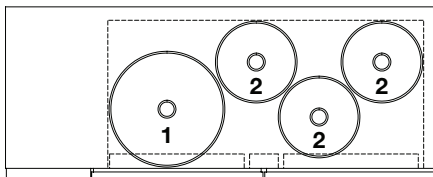



Keg Capacity Guide

For Direct Draw Coolers

MasterTap™



Typical
Half Barrel

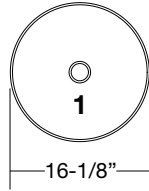

Typical
Quarter Barrel

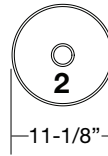

Typical
Sixth Barrel



Two Door Units

Models beginning with DB72

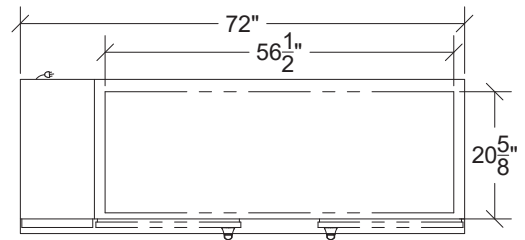

56-1/2" x 20-5/8" Inside Cabinet

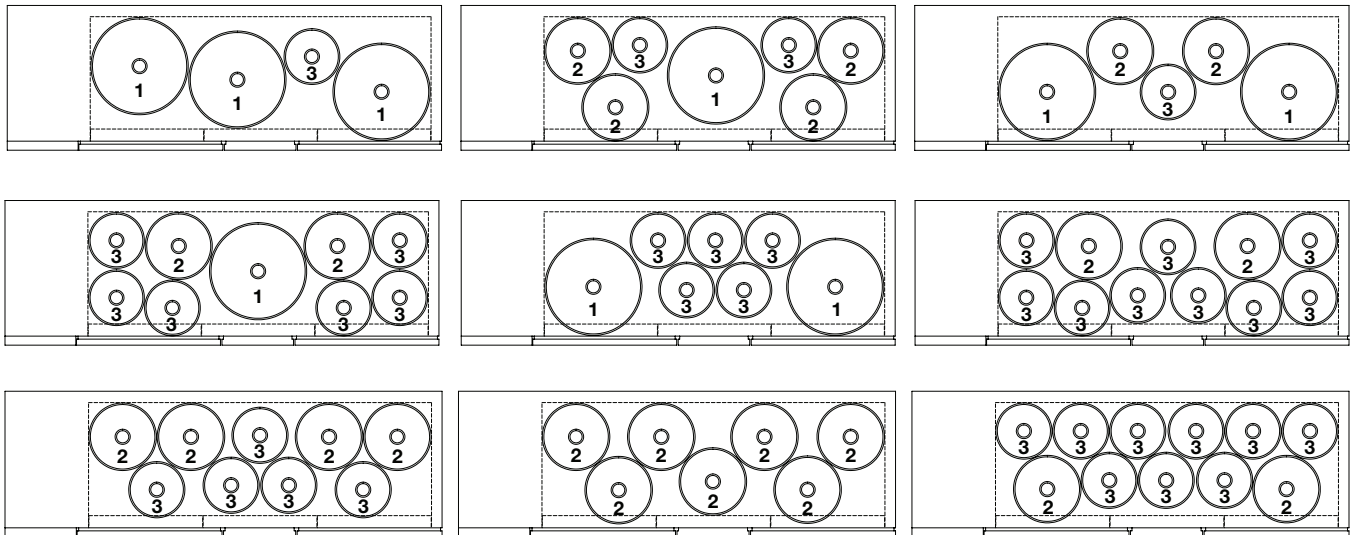



Keg Capacity Guide

For Direct Draw Coolers

MasterTap™



Typical
Half Barrel

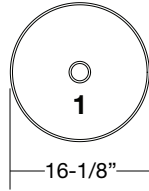

Typical
Quarter Barrel

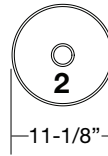

Typical
Sixth Barrel



Three Door Units

Models beginning with DB84

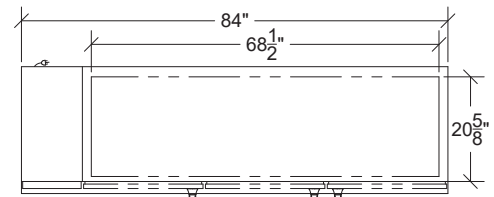

68-1/2" x 20-5/8" Inside Cabinet

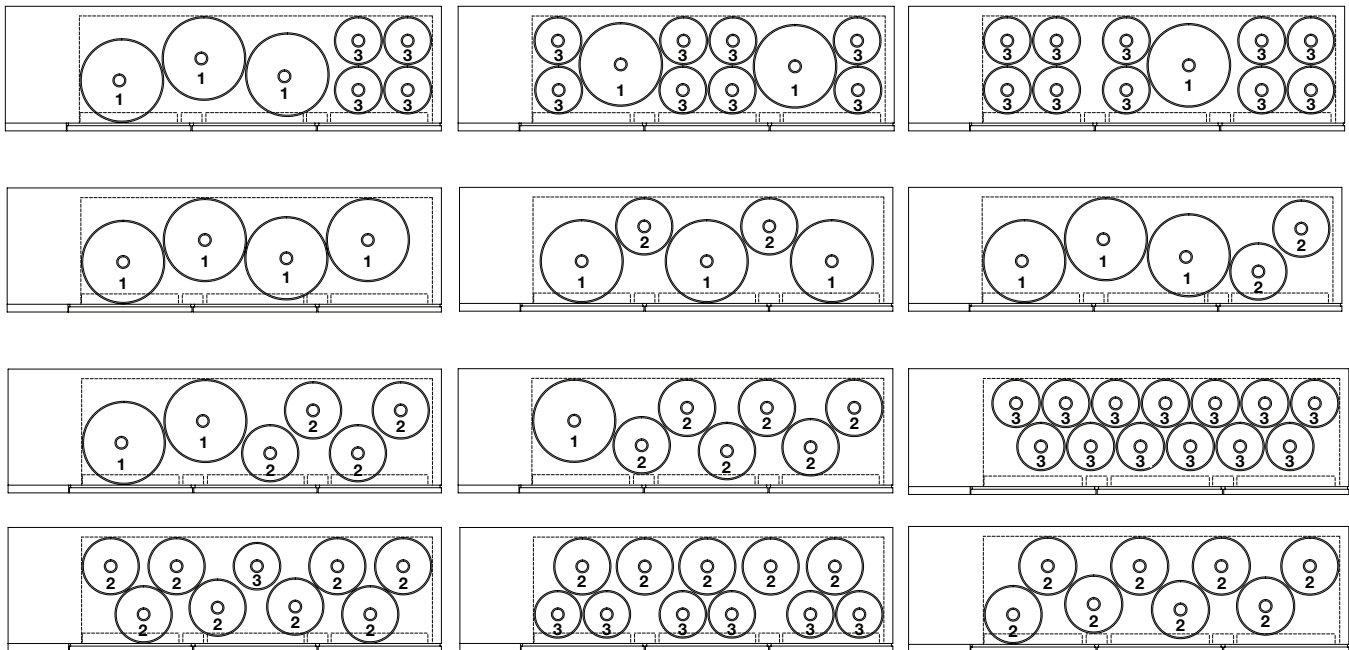



Keg Capacity Guide

For Direct Draw Coolers

MasterTap™



Typical
Half Barrel

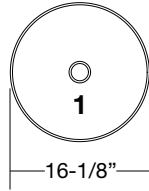

Typical
Quarter Barrel

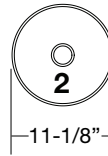

Typical
Sixth Barrel

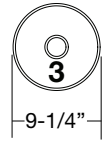

Four Door Units

Models beginning with DB108

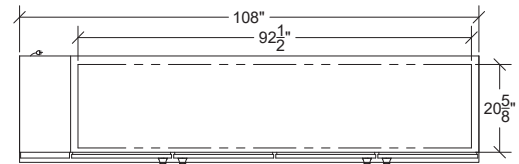

92-1/2" x 20-5/8" Inside Cabinet

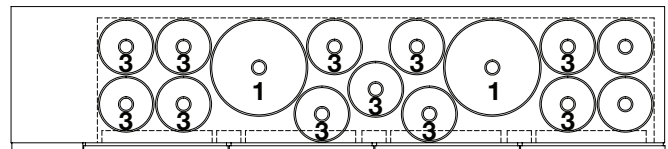
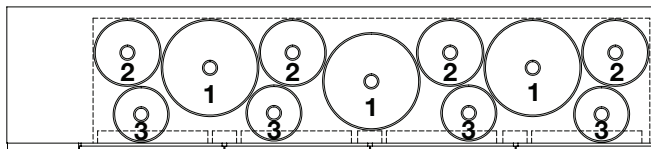
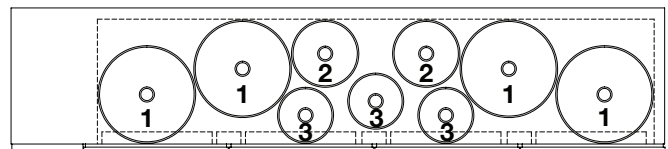
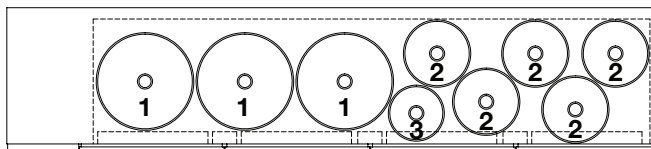
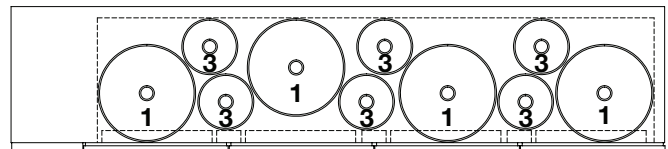
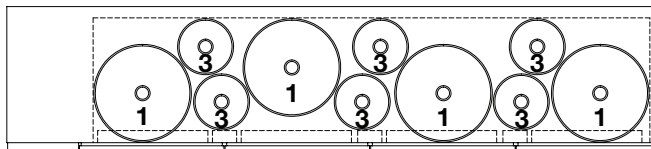
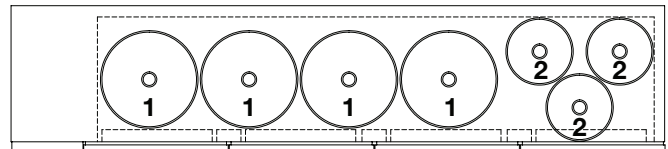
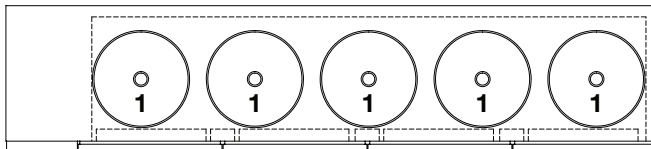

More DB108 configurations on the next page >



Keg Capacity Guide

For Direct Draw Coolers

MasterTap™



Typical
Half Barrel

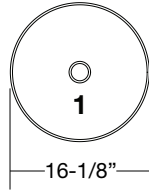

Typical
Quarter Barrel

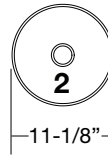

Typical
Sixth Barrel



Four Door Units

(continued)

Models beginning with DB108

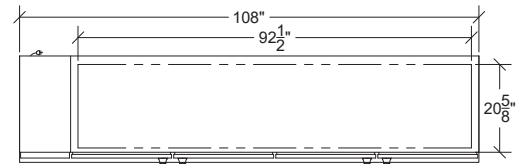

92-1/2" x 20-5/8" Inside Cabinet

